



## The Prepaid Internet and PC Access Card System!

### Short Description

iCafe is a complete internet and PC access control system designed for cafes, copy stores and other public internet access environments. iCafe allows you to control, manage and meter internet/PC access time by using smart cards and the iCafe Manager software.

## Features and Benefits...

### Comprehensive Software

makes set up and card management quick and easy. The iCafe software supports your PC's and customers using wireless laptops.

### Reporting Options

allow you to track cards in use, capture user information and monitor system in real time.

### Demographic Feature

gives you the option to create a customer database.

### Time Remaining Icon

allows customer to view how much time is left on their card.

### Customized Interfaces

are an easy way to communicate to your customers using the text message features.

### Advertising/Promotions

allow you to create loyalty programs and customer rewards.

### Secure Access

insures that users cannot access control panels or modify cards.

### Reusable Cards

can be reprogrammed for new customers over and over again.

### Saves Time

by eliminating the time it takes to set up, monitor and calculate customer's access time.

## How it Works

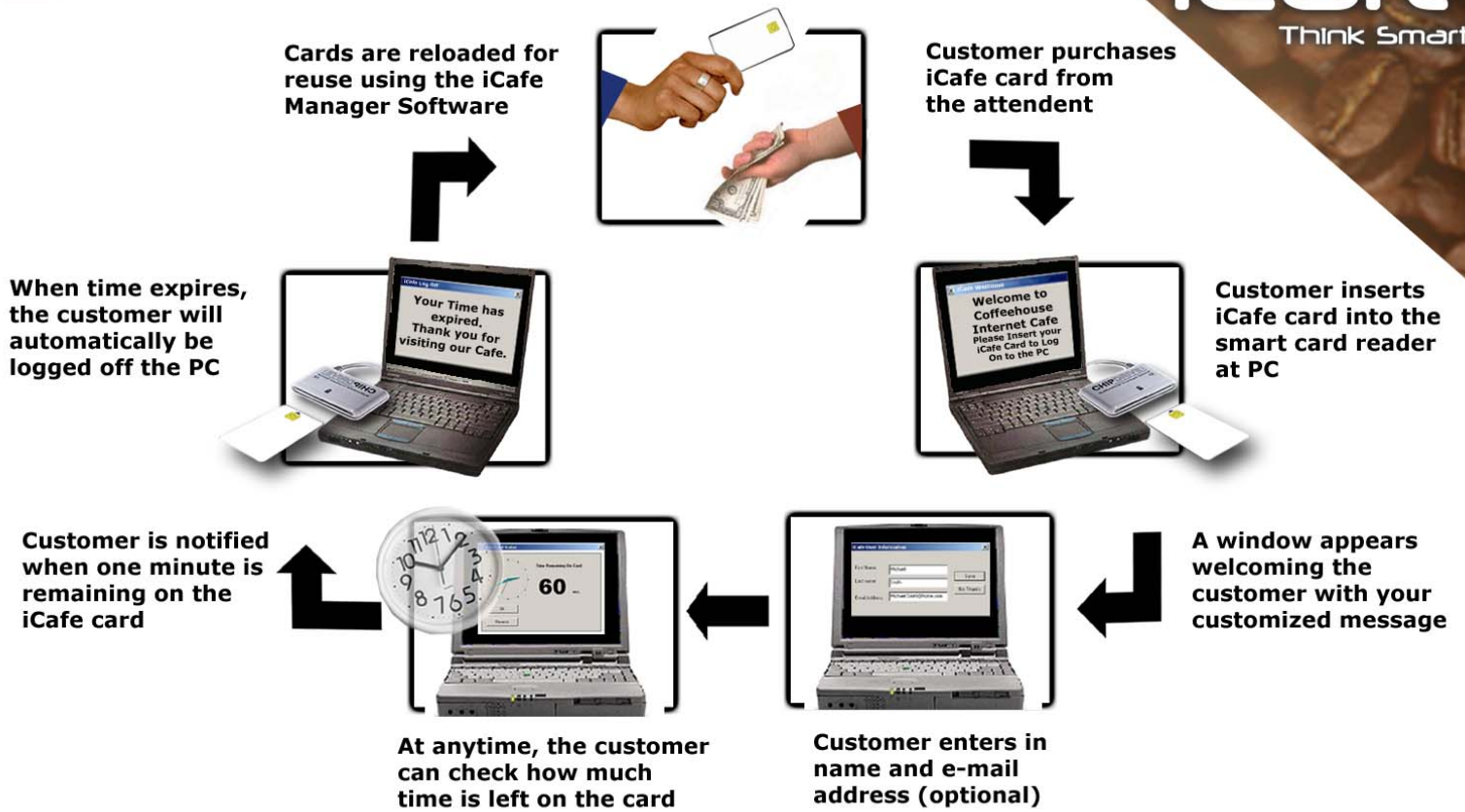

## Components:

### iCafe PC Pack Includes:

iCafe PC Software  
2-iCafe Cards  
Smart Card Reader



### iCafe Manager Includes:

iCafe Manager Software  
iCafe Instruction Guide  
Smart Card Reader



### Smart Card Reader Options:



### System Requirements:



For Serial or USB device: CD  
Microsoft Windows 2000, XP  
At least 5MB of hard disk space available  
Available COM/serial port or USB port

## Configure your system in 5 easy steps:

1. Install the **iCafe Manager Software** and smart card reader onto the Administrator PC; then in the Manager Software open up the Manager Console.
2. Set up the global settings for all iCafe cards in the **System Configuration**.
3. Load and save the settings to the iCafe cards using the **Card Manager**.
4. Create the text messages the customer will view in the **Client Configuration** and save to floppy.
5. Install the **iCafe PC Software** and smart card readers onto the other PC's; set configurations and text messages the customer will view.



**The iCafe System is now complete!**